

UK3+H

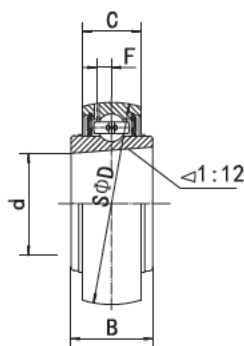

UK3

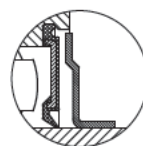

SL Dual seal
(Standard)



L₃ Triple-lip seal
(Optional)



F seal
(Optional)

Bearing NO.	Dimensions (mm / in.)									Dynamic load ratings (N)	Static load ratings (N)	Weight (kg)
	d ₁	d	D	B	C	B ₁	B ₂	d ₂	F			
UK305;H2305 305;HE2305	20 3/4	25 0.9843	62 2.4409	26 1.0236	20 0.7874	35 1.378	8 0.315	38 1.496	5.4 0.213	22400	11500	0.36
UK306;H2306 306;HS2306 306;HE2306	25 7/8 1	30 1.1811	72 2.8346	29 1.1417	23 0.9055	38 1.496	8 0.315	45 1.772	5.7 0.244	26500	14900	0.56
UK307;H2307 307;HS2307	30 1-1/8	35 1.3780	80 3.1496	33 1.2992	25 0.9843	43 1.693	9 0.354	52 2.047	6.2 0.244	33300	19100	0.72
UK308;H2308 308;HE2308 308;HS2308	35 1-1/4 1-3/8	40 1.5748	90 3.5433	34 1.3386	27 1.0630	46 1.811	10 0.394	58 2.283	7.0 0.276	40600	23700	0.99
UK309;H2309 309;HA2309 309;HE2309 309;HS2309	40 1-7/16 1/12 1-5/8	45 1.7717	100 3.9370	37 1.4567	30 1.1611	50 1.969	11 0.433	65 2.559	7.8 0.307	48600	28900	1.29
UK310;H2310 310;HS2310 310;HA2310 310;HE2310	45 1-5/8 1-11/16 1-3/4	50 1.9685	110 4.3307	41 1.6142	32 1.2598	55 2.165	12 0.472	70 2.756	8.5 0.335	62000	38000	1.71
UK311;H2311 311;HS2311 311;HA2311 311;HE2311	50 1-7/8 1-15/16 2	55 2.1654	120 4.7244	44 1.7323	34 1.3386	59 2.323	12 0.472	75 2.953	9.2 0.362	71600	44600	2.08
UK312;H2312 312;HS2312	55 2-1/8	60 2.3622	130 5.1181	47 1.8504	36 1.4173	62 2.441	13 0.512	80 3.150	9.8 0.386	81600	51800	2.88
UK313;H2313 313;HA2313 313;HE2313 313;HS2313	60 2-3/16 2-1/4 2-3/8	65 2.5591	140 5.5118	49 1.9291	38 1.4961	65 2.559	14 0.551	85 3.346	10.5 0.413	93700	60400	3.10
UK315;H2315 315;HA2315 315;HE2315	65 2-7/16 2-1/2	75 2.9528	160 6.2992	55 2.1654	42 1.6535	73 2.874	15 0.591	98 3.858	11.8 0.465	103600	67100	4.76
UK316;H2316 316;HA2316 316;HE2316	70 2-11/16 2-3/4	80 3.1496	170 6.6929	55 2.1654	44 1.7323	78 3.071	17 0.669	105 4.134	12.5 0.492	112800	75700	5.51
UK317;H2317 317;HA2317 317;HE2317	75 2-15/16 3	85 3.3465	180 7.0866	60 2.3622	46 1.8110	82 3.228	18 0.709	110 4.331	13.1 0.516	123500	88200	6.75
UK318;H2318 318;HA2318	80 3-3/16	90 3.5433	190 7.4803	63 2.48	48 1.8898	86 3.386	18 0.709	120 4.724	13.8 0.441	133000	97500	7.62
UK319;H2319 319;HA2319	85 3-5/16	95 3.7402	200 7.874	66 2.5984	50 1.9685	90 3.543	19 0.748	125 4.921	14.7 0.579	144700	110600	9.23
UK320;H2320 320;HA2320	90 3-7/16	100 3.9370	215 8.4646	68 2.6771	54 2.126	97 3.814	20 0.787	130 5.1181	15.7 0.618	173000	141000	10.85
UK322;H2322 322;HA2322	100 3-15/16	110 4.3307	240 9.4488	78 3.0709	60 2.3622	105 4.134	21 0.827	145 5.709	17.7 0.697	205000	179000	14.94
UK324;H2324 324;HA2324	110 4-3/16	120 4.7244	260 10.2362	87 3.4252	64 2.5197	112 4.41	22 0.866	155 6.102	19 0.748	227000	207000	19.29
UK326;H2326 326;HA2326	115 4-7/16	130 5.1181	280 11.0236	87 3.4252	68 2.6771	121 4.764	23 0.908	165 6.496	20 0.787	253000	241000	23.40
UK328;H2328 328;HA2328	125 4-15/16	140 5.5118	300 11.811	97 3.8189	72 2.8189	131 5.158	24 0.945	180 7.087	22 0.866	274000	272000	29.45